



Event Rental





DENVER
art
MUSEUM

The Denver Art Museum offers inspired spaces, sparkling amenities, and the perfect location for your next event.

Our stunning event spaces are ideal for hosting sumptuous galas, corporate receptions, holiday parties, weddings, intimate dinners, and every special event in-between.

INTIMATE GROUPS OF 10 UP TO 10,000 GUESTS

11 INDOOR SPACES AND 5 OUTDOOR SPACES

ACCESS TO THE MUSEUM'S COLLECTIONS AND SPECIAL EXHIBITIONS

IN-HOUSE CATERING AND AUDIOVISUAL

By booking your event at the DAM, you are supporting our mission: to enrich the lives of present and future generations through the acquisition, presentation, and preservation of works of art.

Table of Contents

LANNY AND SHARON MARTIN BUILDING	4
Kemper Courtyard and Amphitheater	6
The Prow Garden	8
The Garden Room	10
Sturm Grand Pavilion	12
South Sturm Pavilion	14
The Seventh Floor Summit Room with Sie & Johnson Terraces	16
Galleries – All Levels	18
The Ponti Restaurant with Terraces	20
The Ponti Private Dining Room	22
 FREDERIC C. HAMILTON BUILDING	 24
Sharp Auditorium and Lobby	26
Sharp Lobby	28
Congdon Boardroom	30
Hamilton Lower Level Package	32
El Pomar Atrium	34
Level Two Atrium	36
Hamilton Atria Package	38
 DENVER ART MUSEUM CAMPUS	 40
 CONTACT US	 42

Lanny and Sharon Martin Building

DENVER ART MUSEUM

EVENT RENTAL

DENVER
art
MUSEUM

About the building

In 1971, the museum opened what is now known as the Martin Building, designed by Italian master of modern design Gio Ponti. This architectural marvel recently underwent a multi-year renovation and now features all new indoor and outdoor event spaces, a restaurant with private dining, and seven floors of collections galleries.

BUILDING CAPACITY: 6500

RECEPTION CAPACITY: 2000

SQUARE FOOTAGE: 210,000

RENTAL FEE

AFTER Museum Hour (4 hrs): \$16,500

NON-PROFIT RATE

AFTER Museum Hour (4 hrs): \$14,850

Priced for a four-hour event rental, with an hour each for setup and teardown. Rental prices include a limited number of tables, chairs, china, and flatware at no additional charge, subject to availability. Rentals during museum hours include complimentary GA entry to the DAM.





ABOUT THE SPACE

Reception capacity : 190
Seated capacity : 2859

LANNY AND SHARON MARTIN BUILDING

Kemper Courtyard and Amphitheater

A beautiful, multi-tiered outdoor space with landscaped trees and lighted paths. Featuring Deborah Butterfield sculptures, an elevated amphitheater, and views of the Martin Building. Kemper Courtyard and Amphitheatre comes with the delightfully designed Wonderscape as an indoor adjacency.

RENTAL FEE

AFTER Museum Hour (4 hrs): \$4,000

NON-PROFIT RATE

AFTER Museum Hour (4 hrs): \$3,600

Extra hour of event time: +\$350/hour

Priced for a four-hour event rental, with an hour each for setup and teardown. Rental prices include a limited number of tables, chairs, china, and flatware at no additional charge, subject to availability. Rentals during museum hours include complimentary GA entry to the DAM.

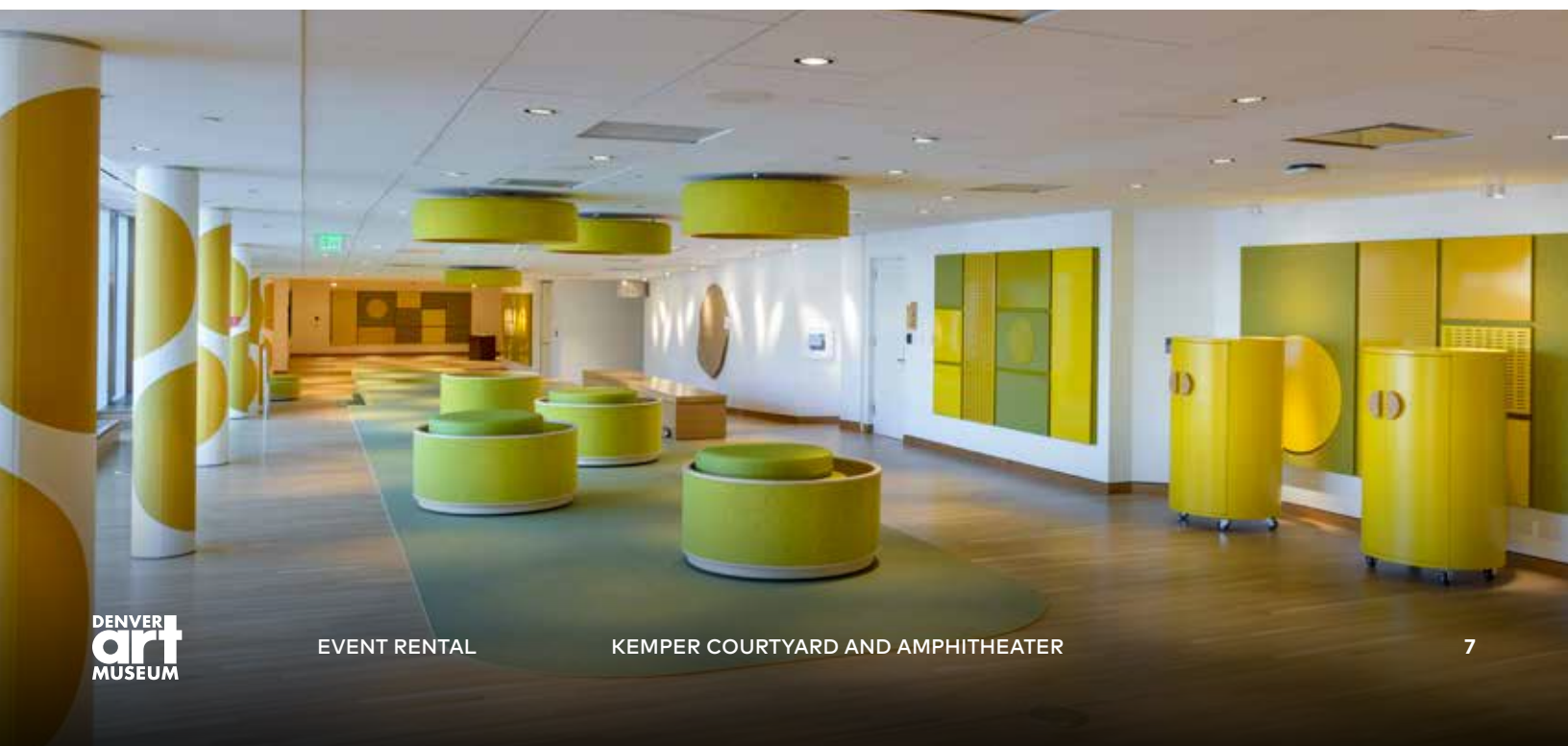
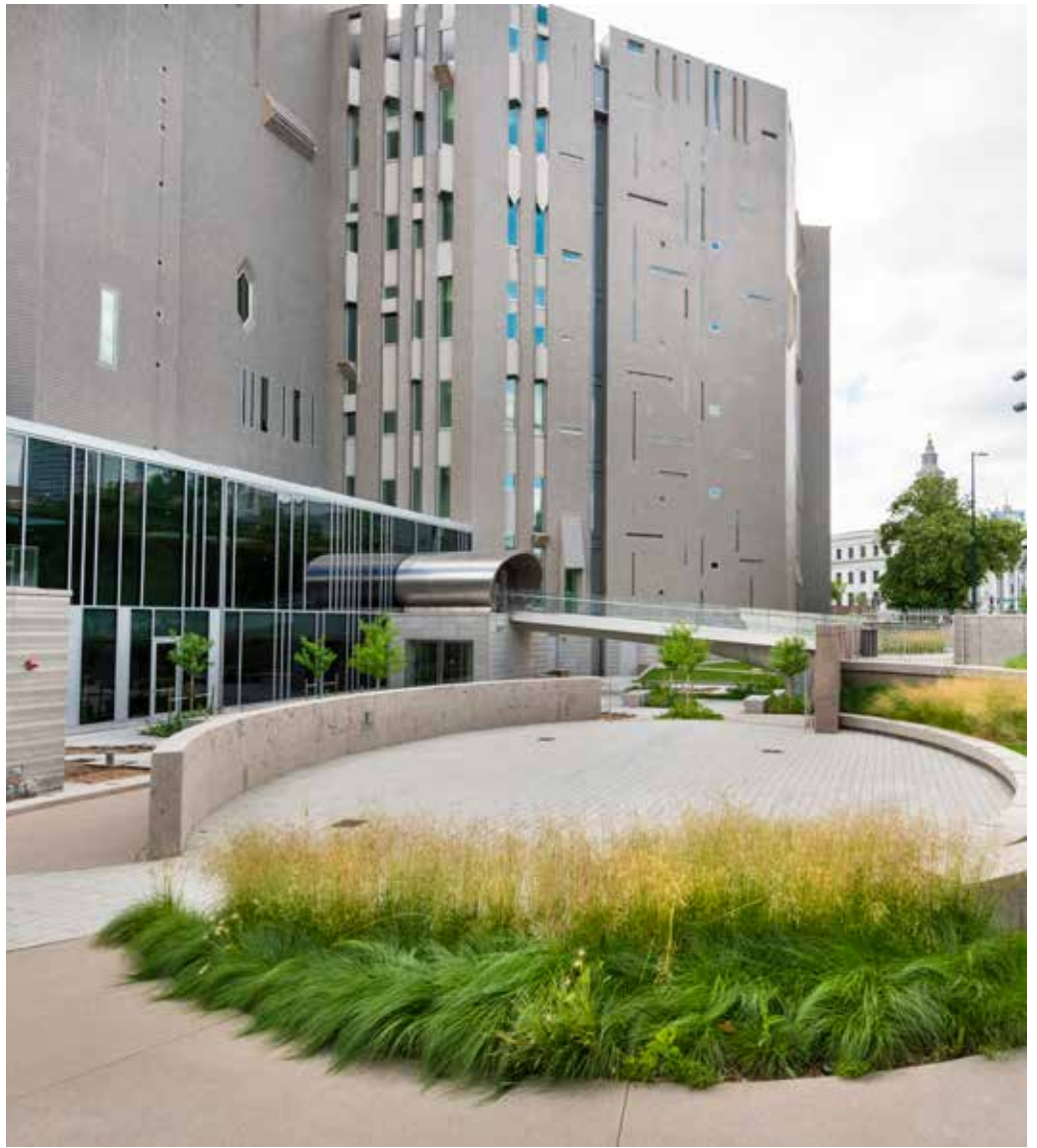



ABOUT THE SPACE

Reception capacity : 200
Square footage : 2993

LANNY AND SHARON MARTIN BUILDING

The Prow Garden

A triangular, paved garden with views of the Denver skyline and Civic Center Park. Seamless event flow with the Garden Room and the Kemper Courtyard and Amphitheatre. Perfect for wedding ceremonies, tributes, cocktail hours, outdoor receptions, and intimate gatherings.

RENTAL FEE

AFTER Museum Hour (4 hrs): \$3,500

NON-PROFIT RATE

AFTER Museum Hour (4 hrs): \$3,150

Priced for a four-hour event rental, with an hour each for setup and teardown. Rental prices include a limited number of tables, chairs, china, and flatware at no additional charge, subject to availability. Rentals during museum hours include complimentary GA entry to the DAM.

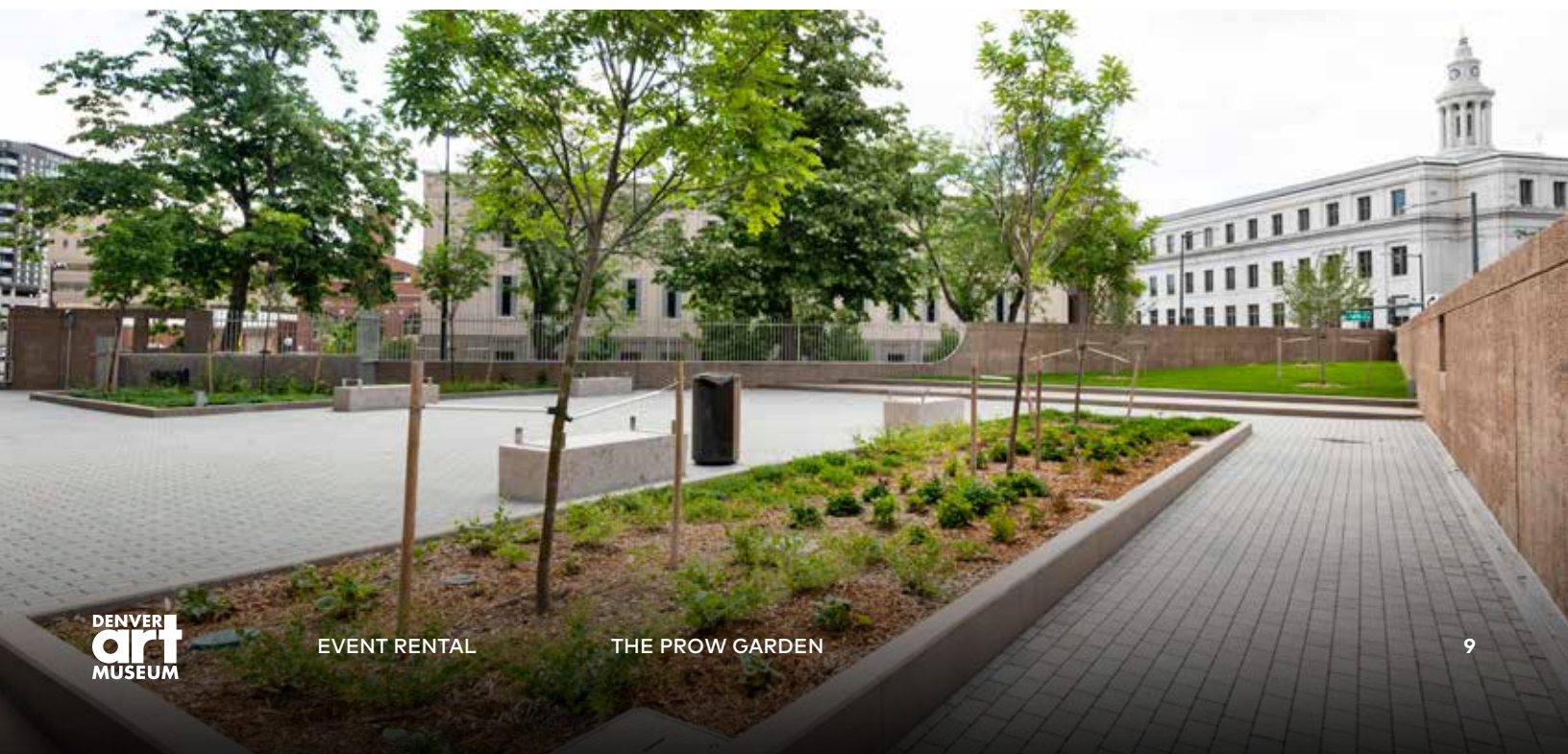



ABOUT THE SPACE

Reception capacity : 80
 Seated capacity : 50
 Square footage : 1053

LANNY AND SHARON MARTIN BUILDING

The Garden Room

A beautiful event space perfect for intimate receptions, staff retreats, rehearsal dinners, or as a staging suite for weddings. The Garden Room features state-of-the art AV, pathways to both the Prow Garden and Sensory Garden, and an exquisite piece by Phillip Taaffe. Available for all-day rental.

RENTAL FEE

AFTER Museum Hour (4 hrs):	\$1,250
DURING Museum Hours:	\$750

NON-PROFIT RATE

OUTSIDE Museum Hour (4 hrs):	\$1,125
DURING Museum Hours:	\$675

Priced for a four-hour event rental, with an hour each for setup and teardown. Rental prices include a limited number of tables, chairs, china, and flatware at no additional charge, subject to availability. Rentals during museum hours include complimentary GA entry to the DAM.



AV PACKAGES

Meeting Package

HDMI or Clickshare
TV Screen
In room PC
A/V Tech

4-hour event: \$750
8-hour event: \$1,500

Hybrid Package

Table Microphones
PTZ camera
Up to 2 microphones

4-hour event: \$1000
8-hour event: \$2000





ABOUT THE SPACE

Reception capacity : 950
 Seated capacity : 500
 Square footage : 14,450

LANNY AND SHARON MARTIN BUILDING

Sturm Grand Pavilion

The Sturm Grand Pavilion is our premiere event space on level two of the Sie Welcome Center. Enclosed in a fluted glass façade, this stunning space provides sweeping views of downtown Denver, state-of-the-art AV, and complimentary access to all galleries on the second level of the Martin Building. For your gala, wedding, holiday party, awards ceremony, or large reception.

RENTAL FEE

AFTER Museum Hour (4 hrs):	\$8,500
DURING Museum Hours:	\$6,000
BEFORE Museum Hours:	\$6,000

*Rental Fee for Grand Sturm includes access to the galleries on view in the Martin Building Second Floor.

NON-PROFIT RATE

AFTER Museum Hour (4 hrs):	\$7,650
DURING Museum Hours:	\$5,400
BEFORE Museum Hours:	\$5,400

Priced for a four-hour event rental, with an hour each for setup and teardown. Rental prices include a limited number of tables, chairs, china, and flatware at no additional charge, subject to availability. Rentals during museum hours include complimentary GA entry to the DAM.

AV PACKAGES

Audio Package:	In-house Stage 16'W x 12'D x 2'H (Optional 16" legs also available)	\$1,500
	Performance Lighting and Stage Wash (Full Color LED Lights & Moving Head Fixtures + Lighting Console)	
	Lectern with Gooseneck Microphone Up to 8 Channels of Wireless Mics	
Projector Package: (includes Stage + Lighting Package Plus)	2 Projectors + Screens (Panasonic 20K Lumen Projectors + 18'W x 10'H Dropdown Screens)	\$3,000
	Portable AV Rack with Video Switcher (Black Magic 4K SDI Switcher + Adapter as Required)	
	Computers for Content Playback (Includes 2 computers)	
	Clicker with Laser Pointer	
Camera Package: (includes both Stage + Lighting and Video Packages Plus)	2 PTZ Cameras (HD Pan + Tilt + Zoom Remote Controlled Cameras + Camera Control)	\$4,500
	Video Recording (Digital HD Recording of Program Video Feed)	
	Optional Livestream Package (Computer, Encoder, DAM Hosted Stream)	





ABOUT THE SPACE

Reception capacity : 295
Theatre style capacity : 315
Seated capacity : 225
Square footage : 4900

LANNY AND SHARON MARTIN BUILDING

South Sturm Pavilion

An airwall partition separates the South Sturm Pavilion into a private event space perfect for luncheons, seated dinners, meetings, and receptions. Offers a large circular space featuring floor-to-ceiling fluted glass windows, state-of-the-art AV, and more. Available for rental before, during, and after museum hours.

RENTAL FEE

AFTER Museum Hour (4 hrs):	\$6,300
DURING Museum Hours:	\$4,250
BEFORE Museum Hours:	\$4,000

NON-PROFIT RATE

AFTER Museum Hour (4 hrs):	\$5,670
DURING Museum Hours:	\$3,825
BEFORE Museum Hours:	\$3,600

Priced for a four-hour event rental, with an hour each for setup and teardown. Rental prices include a limited number of tables, chairs, china, and flatware at no additional charge, subject to availability. Rentals during museum hours include complimentary GA entry to the DAM.

AV PACKAGES

Stage + Lighting Package:

In-house Stage 16'W x 12'D x 2'H
(Optional 16" legs also available)

\$1,500

Performance Lighting and Stage Wash
(Full Color LED Lights & Moving
Head Fixtures + Lighting Console)

Lectern with Gooseneck
Microphone

Up to 8 Channels of Wireless Mics

Video Package: (includes Stage + Lighting Package plus)

2 Projectors + Screens
(Panasonic 20K Lumen Projectors +
18'W x 10'H Dropdown Screens)

\$3,000

Portable AV Rack with Video Switcher
(Black Magic 4K SDI Switcher + Adapter as Required)

Computers for Content Playback
(Includes 2 computers)

Clicker with Laser Pointer

Camera Package: (includes both Stage + Lighting and Video Packages plus)

2 PTZ Cameras
(HD Pan + Tilt + Zoom Remote
Controlled Cameras + Camera Control)

\$4,500

Video Recording
(Digital HD Recording of Program
Video Feed)

Optional Livestream Package
(Computer, Encoder, DAM Hosted Stream)





ABOUT THE SPACE

Summit Room capacity : 35
Johnson Terrace capacity : 100
Sie Terrace capacity : 35
Square footage : 3464

LANNY AND SHARON MARTIN BUILDING

The 7th Floor Summit Room

(WITH SIE AND JOHNSON TERRACES)

A gallery and indoor event space that offer sweeping views of the Front Range from North to South, plus access to two adjoining rooftop terraces. Event rental includes the Summit Room, the Sie and Johnson Terraces, plus access to the north galleries of the Western American Art collection.

RENTAL FEE

AFTER Museum Hour (4 hrs):	\$2,500
DURING Museum Hours:	\$1,500
BEFORE Museum Hours:	\$2,500

NON-PROFIT RATE

AFTER Museum Hour (4 hrs):	\$2,250
DURING Museum Hours:	\$1,350
BEFORE Museum Hours:	\$2,250

Priced for a four-hour event rental, with an hour each for setup and teardown. Rental prices include a limited number of tables, chairs, china, and flatware at no additional charge, subject to availability. Rentals during museum hours include complimentary GA entry to the DAM.



AV PACKAGE

Built in audio for background music
 (1) wireless microphone
 65" TV for presentation
 Podium
 A/V Tech

4-hour event: \$800
 8-hour event: \$1,600

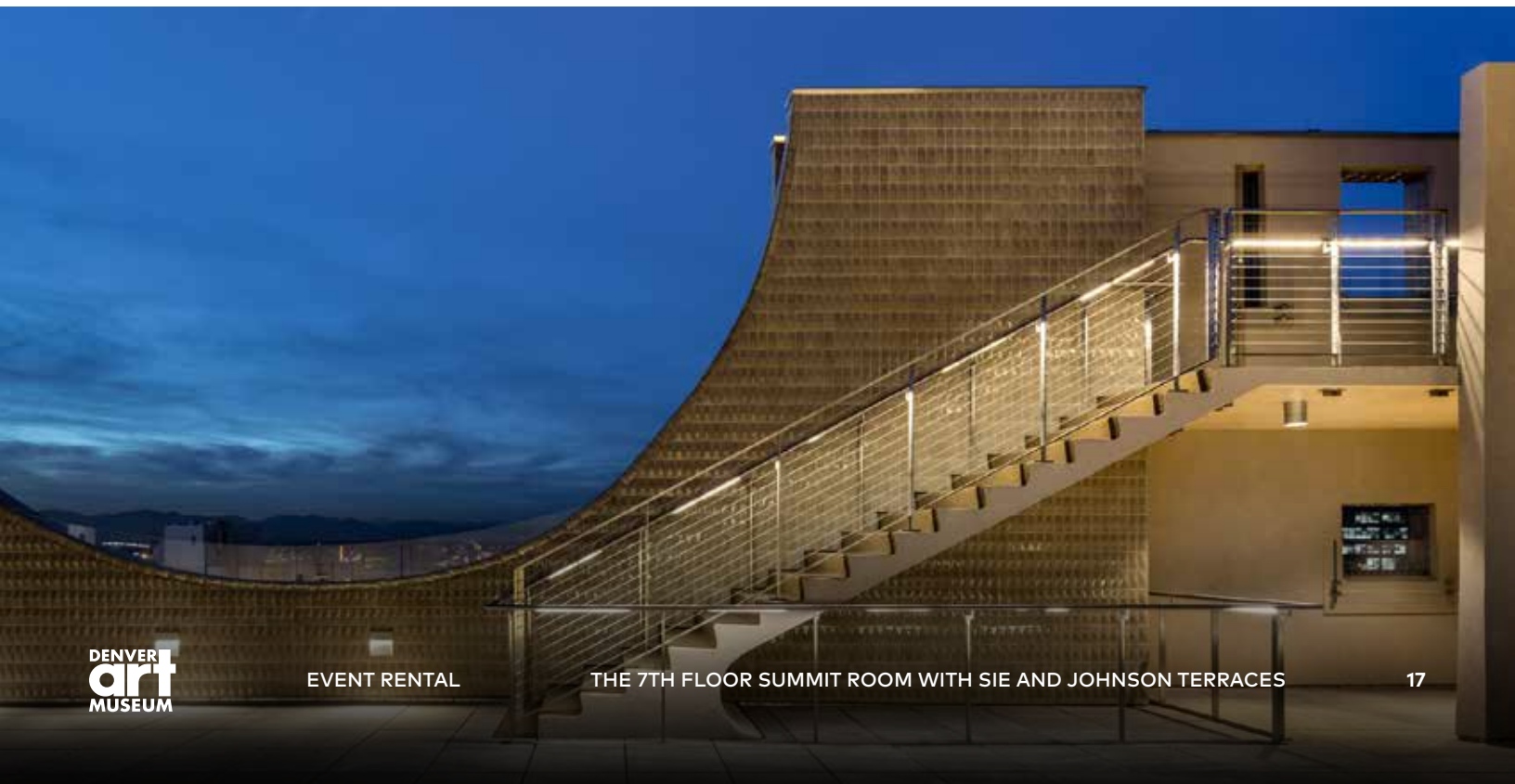



ABOUT THE SPACE

No food or beverages are permitted in any DAM gallery.

Price will vary for special exhibitions.

**LANNY AND SHARON MARTIN BUILDING
& FREDERIC C. HAMILTON BUILDING**

Galleries All Levels

The Martin Building features seven floors of permanent collection galleries and houses a unique and expansive collection on every floor.

The Hamilton Building features both permanent gallery spaces and special exhibition gallery spaces. Current exhibitions include our *19th Century in European and American Art*.

Galleries may be rented for private self-led access, private tours, and more.

RENTAL FEE

AFTER Museum Hour (4 hrs): \$800

NON-PROFIT RATE

AFTER Museum Hour (4 hrs): \$720

Priced for a four-hour event rental, with an hour each for setup and teardown. Rental prices include a limited number of tables, chairs, china, and flatware at no additional charge, subject to availability. Rentals during museum hours include complimentary GA entry to the DAM.



AV PACKAGE

(2) speakers, wireless microphone,
background music
(10) Uplights
(1) A/V Tech

4-hour event: \$800
8-hour event: \$1,600





ABOUT THE SPACE

Seated capacity : 123
Square footage : 1382

LANNY AND SHARON MARTIN BUILDING

The Ponti Restaurant

(WITH TERRACE)

The Ponti Restaurant combines art and elegant dining with a locally-sourced and inspired menu designed by James Beard Award winner and celebrated Denver chef Jennifer Jasinski.

RENTAL FEE

AFTER Museum Hour (4 hrs):	\$1,200
DURING Museum Hours:	\$800

NON-PROFIT RATE

AFTER Museum Hour (4 hrs):	\$1,080
DURING Museum Hours:	\$720

Food and Beverage Minimums Can Apply.





ABOUT THE SPACE

Seated capacity : 32

Square footage : 638

LANNY AND SHARON MARTIN BUILDING

The Ponti Private Dining Room

The Ponti Private Dining Room is a sophisticated dining space equipped with state-of-the-art AV and elegant aesthetics. Perfect for intimate gatherings, corporate meetings, rehearsal dinners, and more.

RENTAL FEE

AFTER Museum Hour (4 hrs):

F&B Min + \$550

DURING Museum Hours:

F&B Min



AV PACKAGE

Built in audio for background music
Podium
98" TV for presentation
(1) Microphone (if needed)
A/V Tech

4-hour event: \$600
8-hour event: \$1,200



Frederic C. Hamilton Building

DENVER ART MUSEUM

EVENT RENTAL

DENVER
art
MUSEUM

About the building

The Hamilton Building's iconic Daniel Libeskind-designed architecture is adaptable to events of all formats and scale. It offers easy access to extraordinary art experiences, such as past exhibitions like *Star Wars™ and the Power of Costume*, *Claude Monet: The Truth of Nature*, and *Dior: From Paris to the World*, to name a few.

BUILDING CAPACITY: 4000

RECEPTION CAPACITY: 800

SQUARE FOOTAGE: 146,000

RENTAL FEE

AFTER Museum Hour (4 hrs): \$11,000

NON-PROFIT RATE

AFTER Museum Hour (4 hrs): \$9,900

Priced for a four-hour event rental, with an hour each for setup and teardown. Rental prices include a limited number of tables, chairs, china, and flatware at no additional charge, subject to availability. Rentals during museum hours include complimentary GA entry to the DAM.





ABOUT THE SPACE

Auditorium capacity : 266
Lobby capacity : 125
Seated capacity : 60
Lobby square footage : 950

FREDERIC C. HAMILTON BUILDING

Sharp Auditorium and Lobby

The Lewis I. Sharp Auditorium provides a dynamic touch for corporate meetings, symposiums, keynote addresses, lectures, or conferences. Includes use of the Sharp Lobby for registration and reception.

RENTAL FEE

OUTSIDE Museum Hour (4 hrs):	\$1,600
DURING Museum Hours:	\$1,250

NON-PROFIT RATE

AFTER Museum Hour (4 hrs):	\$1,440
DURING Museum Hours:	\$1,125

Priced for a four-hour event rental, with an hour each for setup and teardown. Rental prices include a limited number of tables, chairs, china, and flatware at no additional charge, subject to availability. Rentals during museum hours include complimentary GA entry to the DAM.



AV PACKAGES

Audio & Projector Package

House & Stage Lighting
 Projector
 Up to 8 wireless microphones
 Laptop and clicker
 A/V Tech

4-hour event: \$750
 8-hour event: \$1,500

Recording Package

Camera
 Video
 Livestream
 Confidence monitor
 A/V Tech
(This package includes everything in the Audio + Projector Package)

4-hour event: \$1500
 8-hour event: \$3000





ABOUT THE SPACE

Reception capacity : 125
Seated capacity : 60
Square footage : 950

FREDERIC C. HAMILTON BUILDING

Sharp Lobby

An open, angular, and interesting event space directly outside of Sharp Auditorium and Congdon Boardroom. Featuring models by designer Herbert Bayer.

RENTAL FEE

OUTSIDE Museum Hour (4 hrs):	\$1,000
DURING Museum Hours:	\$500

NON-PROFIT RATE

OUTSIDE Museum Hour (4 hrs):	\$900
DURING Museum Hours:	\$450

Priced for a four-hour event rental, with an hour each for setup and teardown. Rental prices include a limited number of tables, chairs, china, and flatware at no additional charge, subject to availability. Rentals during museum hours include complimentary GA entry to the DAM.

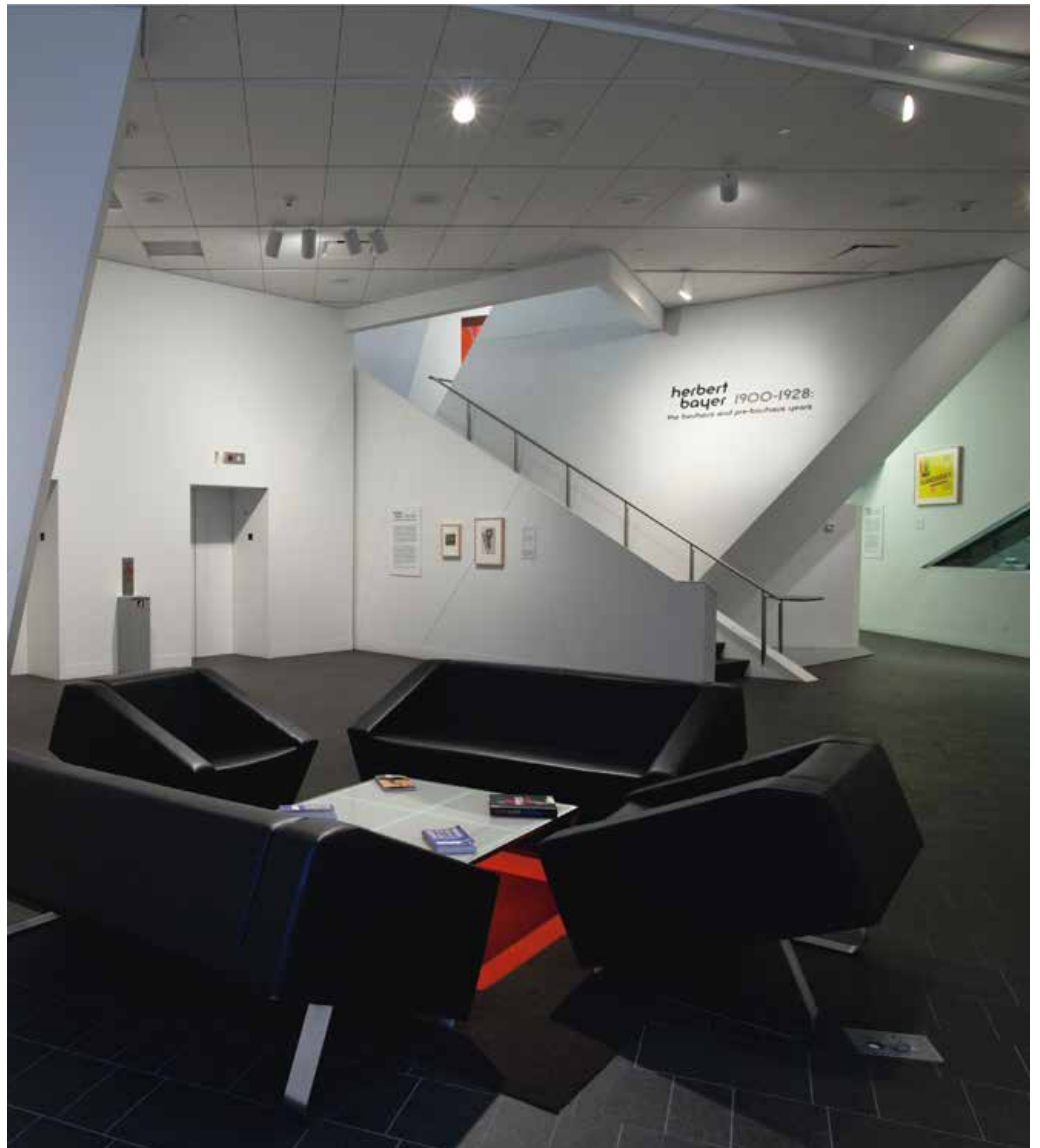



ABOUT THE SPACE

Seated capacity : 50
Square footage : 1110

FREDERIC C. HAMILTON BUILDING

Congdon Boardroom

The Congdon Boardroom provides an elegant setting for meetings, events, and corporate retreats. The room is beautifully adorned with bold, modern textiles by Alexander Calder.

RENTAL FEE

OUTSIDE Museum Hour (4 hrs):	\$1,000
DURING Museum Hours:	\$500

NON-PROFIT RATE

OUTSIDE Museum Hour (4 hrs):	\$900
DURING Museum Hours:	\$450

Priced for a four-hour event rental, with an hour each for setup and teardown. Rental prices include a limited number of tables, chairs, china, and flatware at no additional charge, subject to availability. Rentals during museum hours include complimentary GA entry to the DAM.



AV PACKAGES

Meeting Package

HDMI or Clickshare
 Projector
 Background music/audio
 In room PC
 A/V Tech
 Staff

4-hour event: \$750
 8-hour event: \$1,500

Hybrid Package 2

Table Microphones
 PTZ camera
 Up to 2 microphones
 A/V Tech
 Staff

4-hour event: \$1000
 8-hour event: \$2000

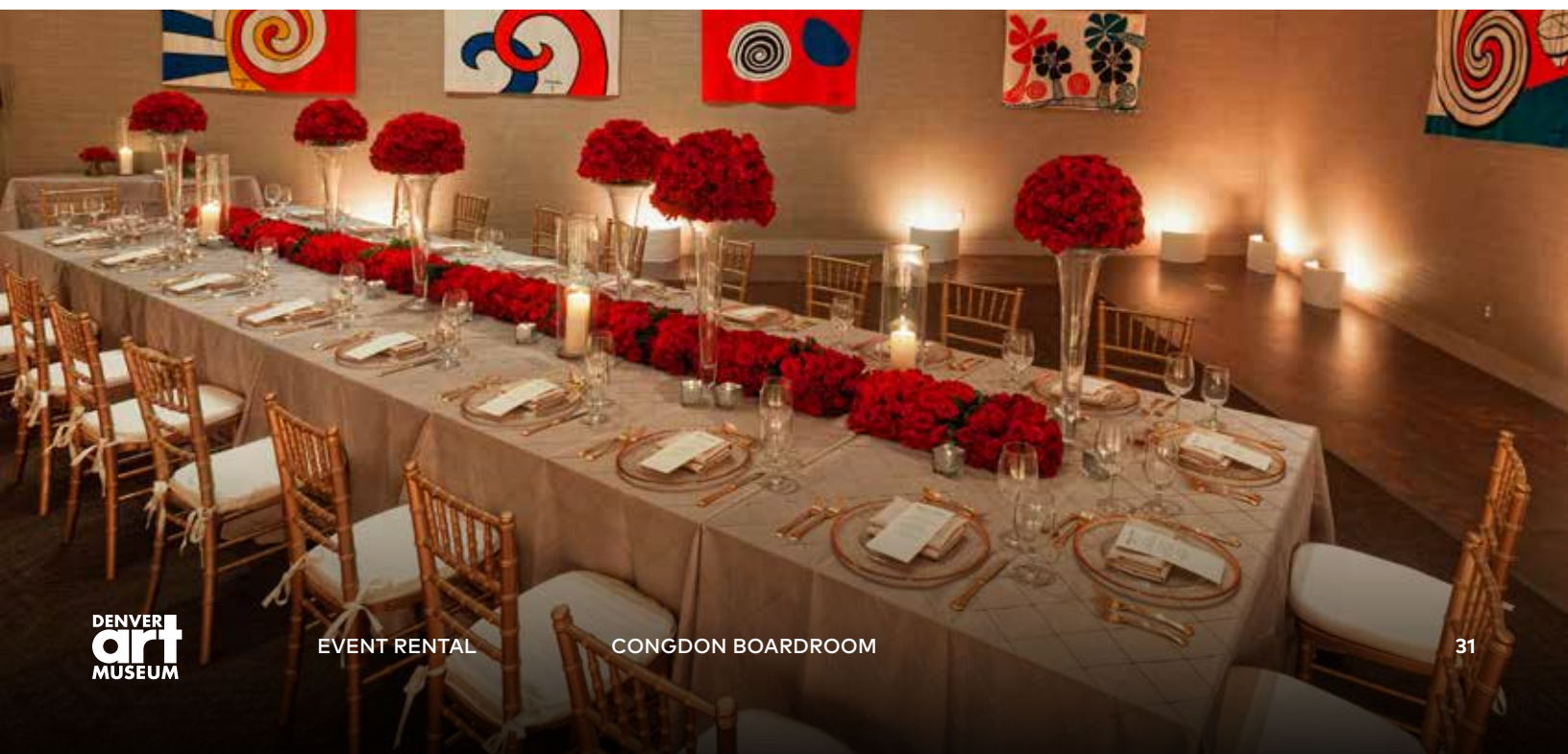



ABOUT THE SPACE

Auditorium capacity: 275
 Lobby capacity: 125
 Congdon Boardroom capacity: 50
 Square footage: 2050
 (plus auditorium)

FREDERIC C. HAMILTON BUILDING

Hamilton Lower Level Package

SHARP AUDITORIUM | SHARP LOBBY |
 CONGDON BOARDROOM

Enjoy private access to the entire lower level of the Hamilton Building. Perfect for conferences, lectures, and programs in need of break-out, VIP, or green room areas plus private reception space.

RENTAL FEE

OUTSIDE Museum Hour (4 hrs):	\$2,500
DURING Museum Hours:	\$1,750

NON-PROFIT RATE

AFTER Museum Hour (4 hrs):	\$2,250
DURING Museum Hours:	\$1575

Priced for a four-hour event rental, with an hour each for setup and teardown. Rental prices include a limited number of tables, chairs, china, and flatware at no additional charge, subject to availability. Rentals during museum hours include complimentary GA entry to the DAM.

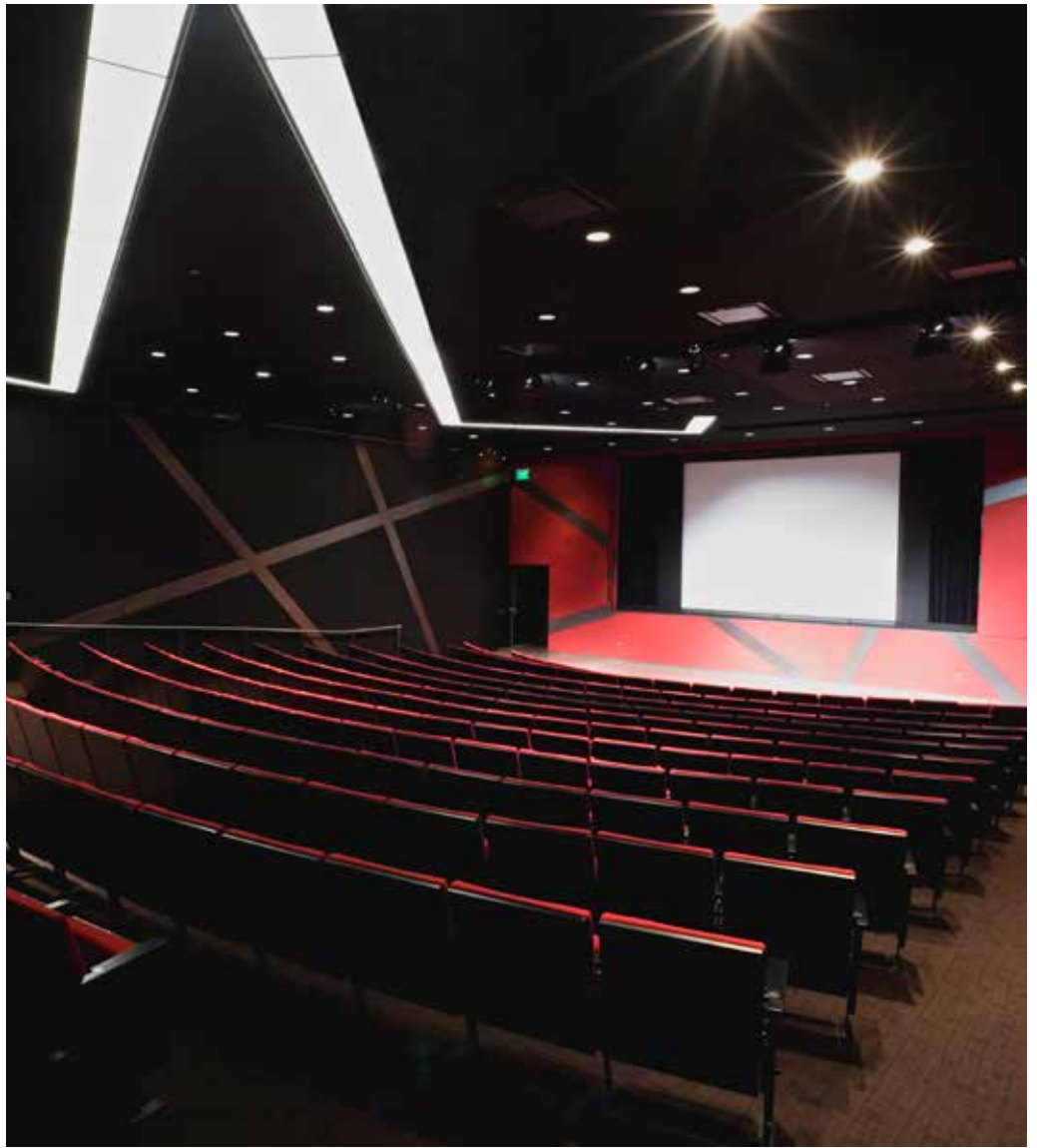



ABOUT THE SPACE

Reception capacity: 400
Seated capacity: 175
Square footage: 5000
Number of Floors: 1

FREDERIC C. HAMILTON BUILDING

El Pomar Atrium

Sloping walls, black granite floors, a magnificent staircase, and dynamic architectural design. The El Pomar Atrium features stunning event space and convenient access to fresh exhibitions at the DAM.

RENTAL FEE

AFTER Museum Hour (4 hrs): \$4,000

NON-PROFIT RATE

AFTER Museum Hour (4 hrs): \$3,600

Priced for a four-hour event rental, with an hour each for setup and teardown. Rental prices include a limited number of tables, chairs, china, and flatware at no additional charge, subject to availability. Rentals during museum hours include complimentary GA entry to the DAM.

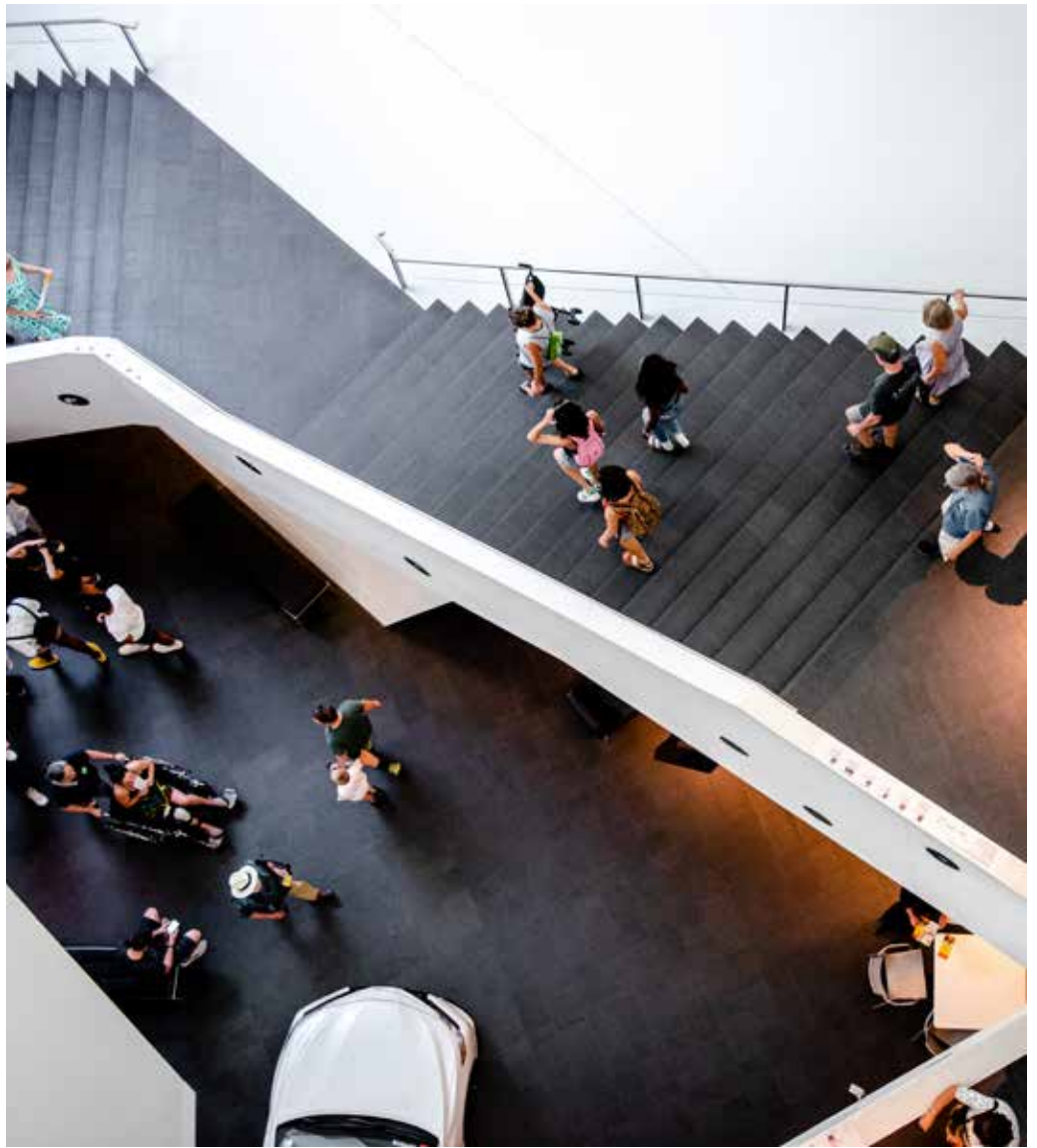



ABOUT THE SPACE

Reception capacity: 250
Seated capacity: 80
Square footage: 1274
Number of Floors: 1

FREDERIC C. HAMILTON BUILDING

Level Two
Atrium

A mid-size event space directly adjacent to the DAM's special exhibition galleries and the *19th Century in European and American Art* painting and sculpture galleries. The Level Two Atrium provides impressive architectural views, event space in-the-round, and close proximity to Sturm Grand Pavilion via the Reiman Bridge.

RENTAL FEE

AFTER Museum Hour (4 hrs): \$2,500

NON-PROFIT RATE

AFTER Museum Hour (4 hrs): \$2,250

Priced for a four-hour event rental, with an hour each for setup and teardown. Rental prices include a limited number of tables, chairs, china, and flatware at no additional charge, subject to availability. Rentals during museum hours include complimentary GA entry to the DAM.



AV PACKAGE

(2) speakers, wireless microphone,
background music
(10) Uplights
(1) A/V Tech

4-hour event: \$800

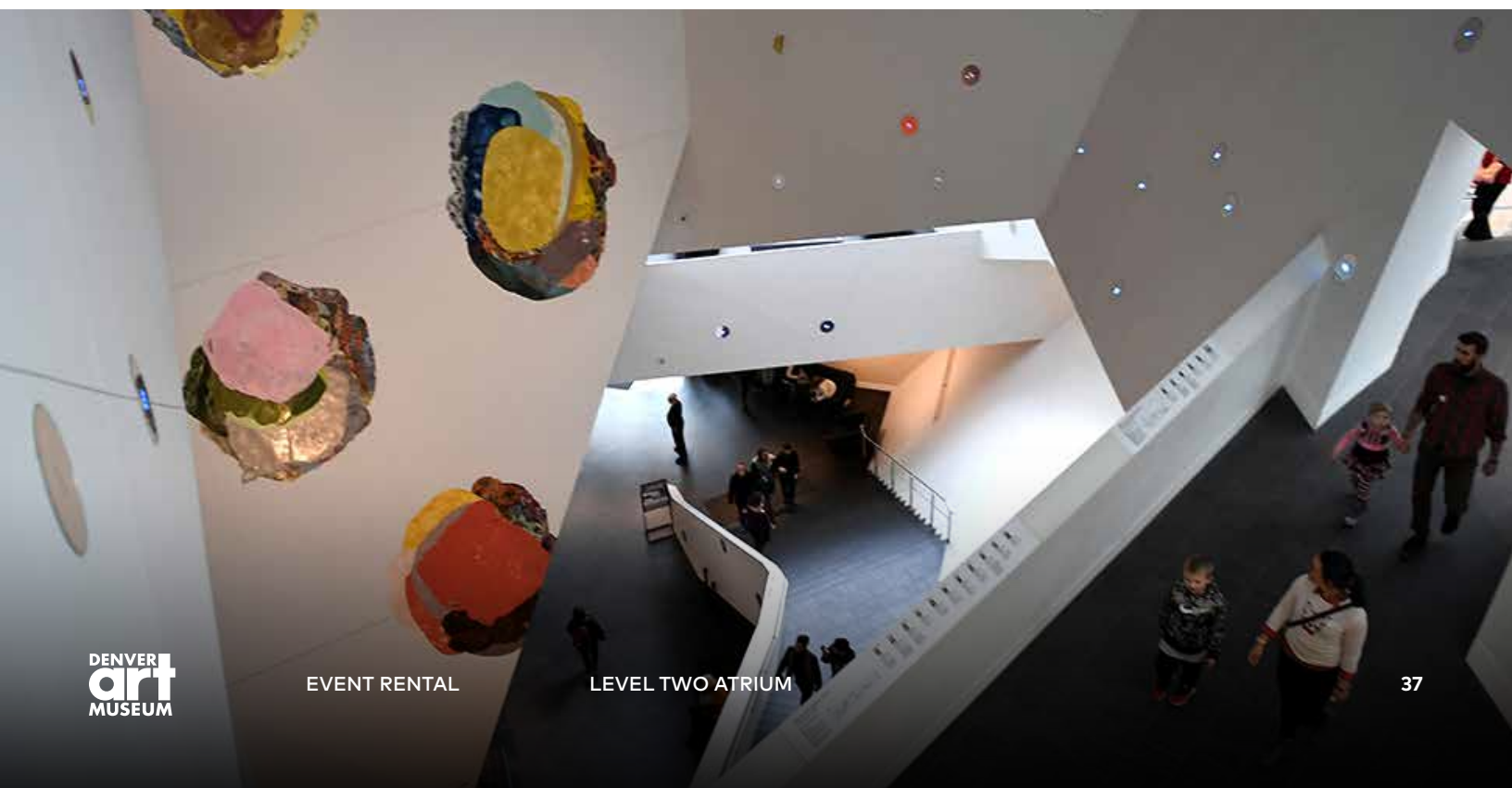



ABOUT THE SPACE

Reception capacity: 650
Seated capacity: 275
Square footage: 6274
Number of Floors: 2

FREDERIC C. HAMILTON BUILDING

Hamilton Atria Package

EL POMAR ATRIUM | LEVEL TWO ATRIUM

For a complete event experience in the Hamilton Building, the EL Pomar and Level Two Atria combine to provide the perfect atmosphere for large parties and unforgettable occasions.

RENTAL FEE

AFTER Museum Hour (4 hrs): \$5,000

NON-PROFIT RATE

AFTER Museum Hour (4 hrs): \$4,500

Priced for a four-hour event rental, with an hour each for setup and teardown. Rental prices include a limited number of tables, chairs, china, and flatware at no additional charge, subject to availability. Rentals during museum hours include complimentary GA entry to the DAM.



AV PACKAGE

(4+) speakers, podium, wireless mic,
background music
(25) Uplights
(2) A/V Tech

4-hour event: \$1,400
8-hour event: \$2,800

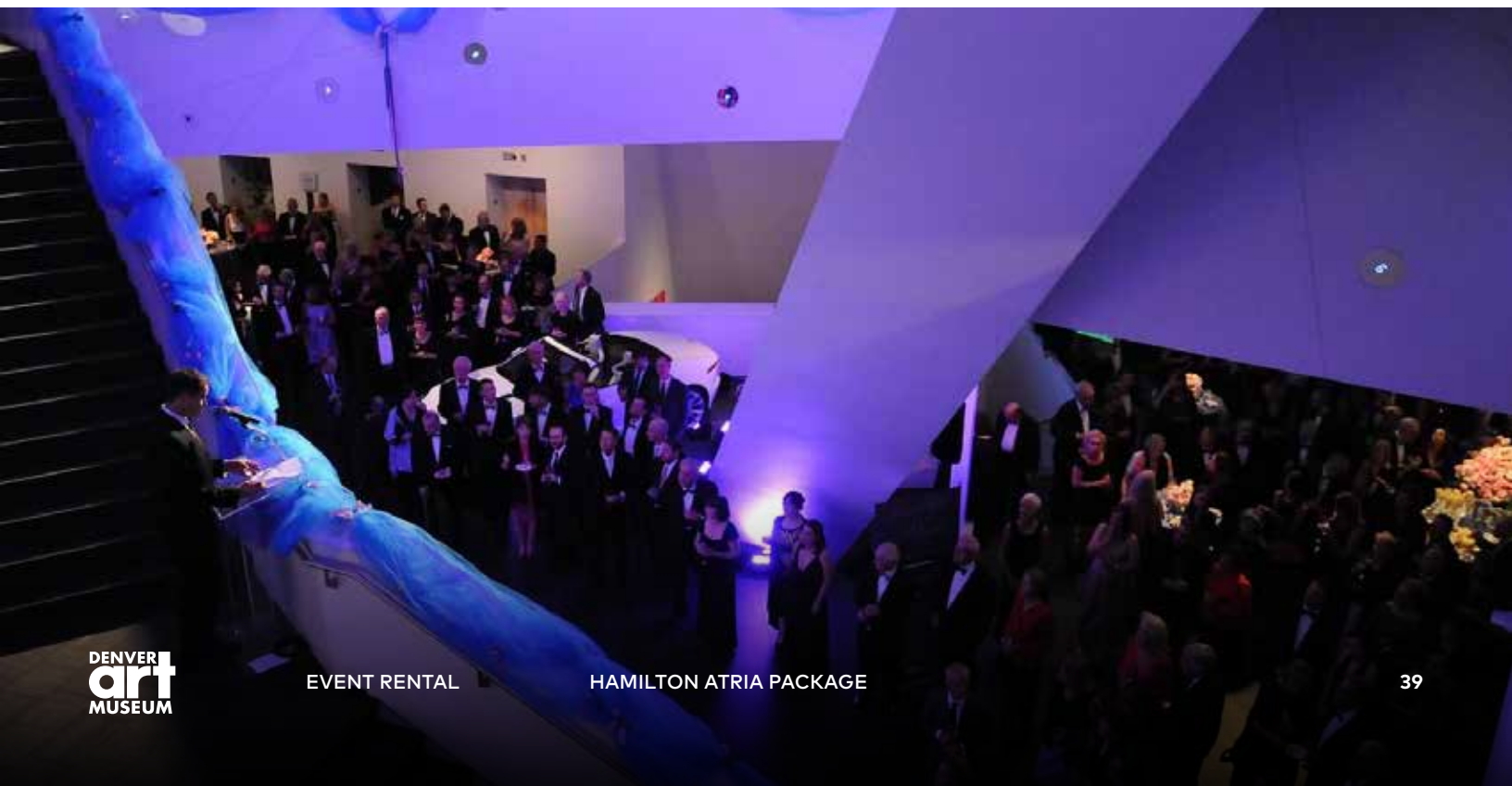

Denver Art Museum Campus



DENVER ART MUSEUM

EVENT RENTAL

DENVER
art
MUSEUM

About the campus

The full campus of the Denver Art Museum is available for private bookings after museum hours. Sold as a campus buyout with access to all indoor and outdoor event spaces, galleries, special exhibitions, and more!

CAMPUS CAPACITY: 10,000

RECEPTION CAPACITY: 2,800

SQUARE FOOTAGE: 356,000

RENTAL FEE

AFTER Museum Hour (4 hrs): \$24,000

NON-PROFIT RATE

AFTER Museum Hour (4 hrs): \$21,600

Priced for a four-hour event rental, with an hour each for setup and teardown. Rental prices include a limited number of tables, chairs, china, and flatware at no additional charge, subject to availability. Rentals during museum hours include complimentary GA entry to the DAM.



For more information on our rental program, catering information, capabilities, event guidelines and more:

CONTACT

Mary Beth Maggio | *Senior Manager of Event Sales*
720-913-0148
mmaggio@denverartmuseum.org

Katelyn Peterson | *Director of Catering Sales*
(720) 913-0061
kpeterson@denverartmuseum.org



© Martin Building images by James Florio. Unless otherwise noted, photos are by Christina Jackson or Eric Stephenson.



THE DAM OFFERS NONPROFIT PRICING ON SPACE RENTAL

CORPORATE PARTNERSHIP OFFERS COMPED EVENT SPACE AND ADDITIONAL BENEFITS

IN-HOUSE CATERING AT THE DENVER ART MUSEUM WILL FULFILL ALL OF YOUR CATERING NEEDS



FOR MORE INFORMATION, PLEASE VISIT:

denverartmuseum.org/event-rental